

# HEAVY DUTY FLUSH LIFT RING

316 STAINLESS STEEL



Import



Precision  
Cast

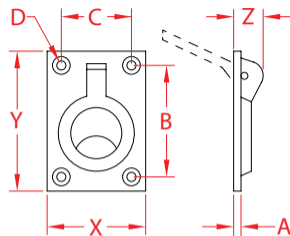

ITEM	A	B	C	D	X (height)	Y (length)	Z (width)	WT (lb)	PACKAGING TYPE	EACH (qty)	INNER (qty)	CARTON (qty)	UPC
S3851-0000	0.13"	1.90"	1.23"	0.15"	1.72"	2.45"	0.31"	0.19	POLYBAG	1	1	200	791506058328
S3851-0001	0.22"	1.47"	1.13"	0.17"	1.49"	1.87"	0.49"	0.10	POLYBAG	1	1	200	791506058335

**NOTE:**

**USE 4 #8 FASTENERS. HEAVY DUTY LIFT RINGS WITH PRECISION CAST COMPONENTS.**

**REFERENCE "FASTENER MATCHING CHART" FOR COMPATIBLE FASTENERS.**

**ALL DIMENSIONS ARE NOMINAL (+/- 3%) AND ARE SUBJECT TO CHANGE WITHOUT NOTICE.**